

FAG

6016-2Z

Deep groove ball bearing

Schaeffler ID:
0167181860000Deep groove ball bearing 60...-2Z, single
row, shields, steel sheet metal cage

Technical information

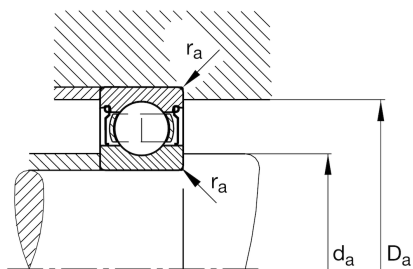
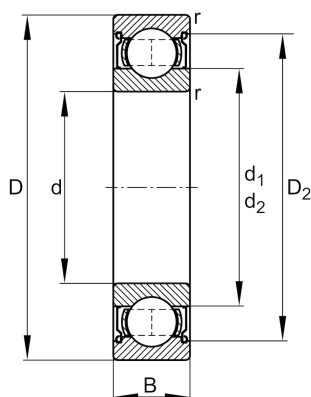
**Main Dimensions & Performance Data**

d	80 mm	Bore diameter
D	125 mm	Outside diameter
B	22 mm	Width
C_r	51.000 N	Basic dynamic load rating, radial
C_{0r}	40.000 N	Basic static load rating, radial
C_{ur}	2.410 N	Fatigue load limit, radial
n_G	6.300 1/min	Limiting speed
n_{gr}	6.100 1/min	Reference speed
	0,893 kg	Weight

Dimensions

r_{min}	1,1 mm	Minimum chamfer dimension
D_2	113,7 mm	Caliber diameter outer ring
d_1	93,7 mm	Shoulder diameter inner ring

Mounting dimensions

d_{amin}	86 mm	Minimum diameter shaft shoulder
D_{amax}	119 mm	Maximum diameter of housing shoulder
r_{amax}	1 mm	Maximum fillet radius

Calculation factors

f_0	15,7	Calculation factor
-------	------	--------------------

Temperature range

T_{min}	-20 °C	Operating temperature min.
T_{max}	120 °C	Operating temperature max.